

F07 & FA07 BASES

OPTIONAL ON AQ105/115/130/310

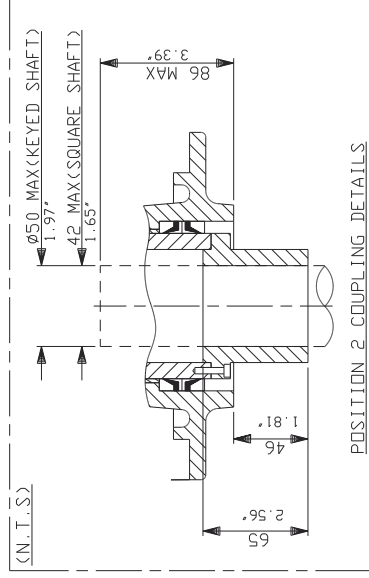
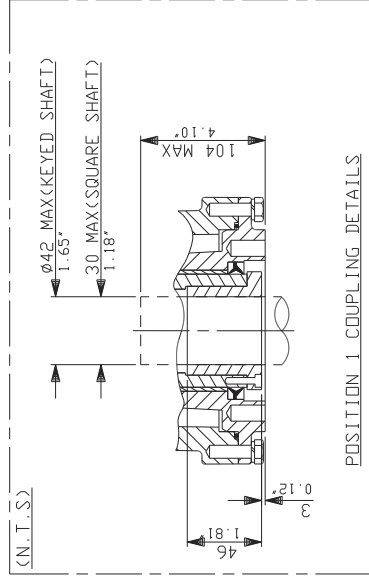
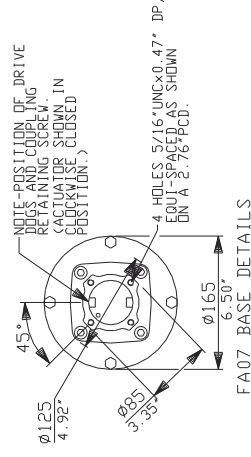
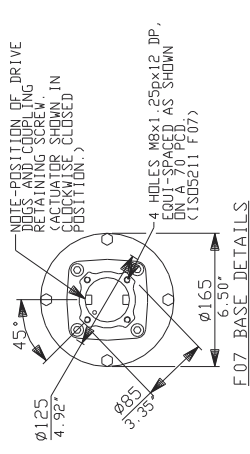

F10 & FA10 BASES

STANDARD FOR AQ100/300



Rotork Controls Ltd
Bath, England BA1 1JD
Bath, GRES175E00

AQ100/300 BASES

Date 141097

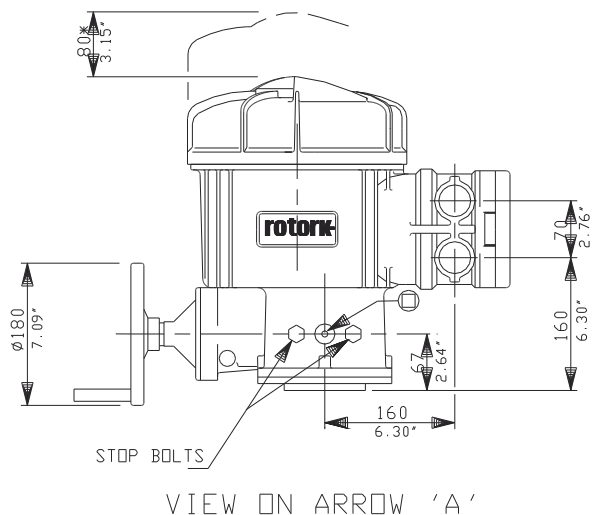
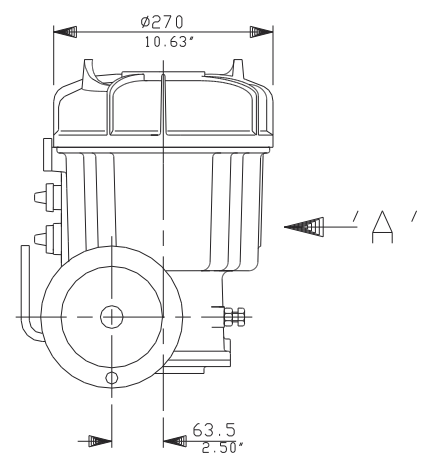
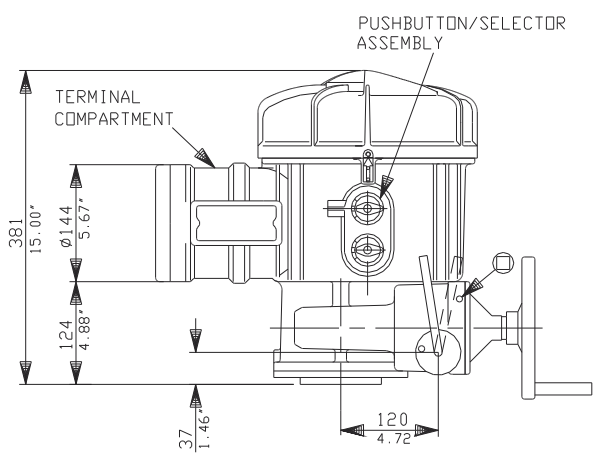
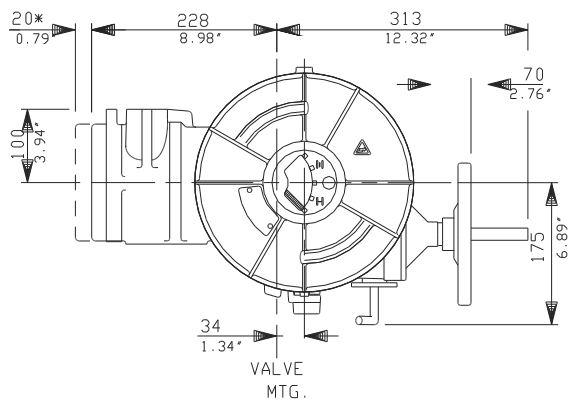

CONDUIT ENTRIES (N.T.S)

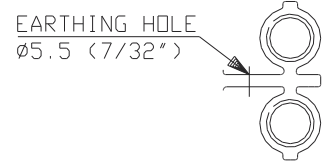

TAPPED 2 X 1 1/4" NPT
STANDARD ALTERNATIVES IF SPECIFIED
2 X M32
2 X PG21

ACTUATOR SHOWN WITH F10 BASE.

rotork	Rotork Controls Ltd. Bath, England BA1 3JU Bath (01225)733200
	AQ100/300 DATA
	Date 141097