

ACTUATOR TYPE - M07/DB1

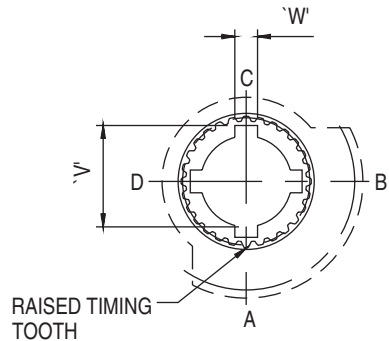
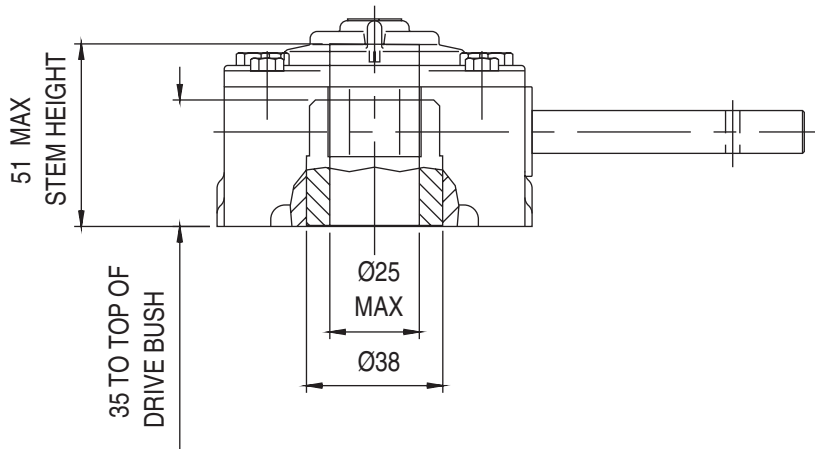
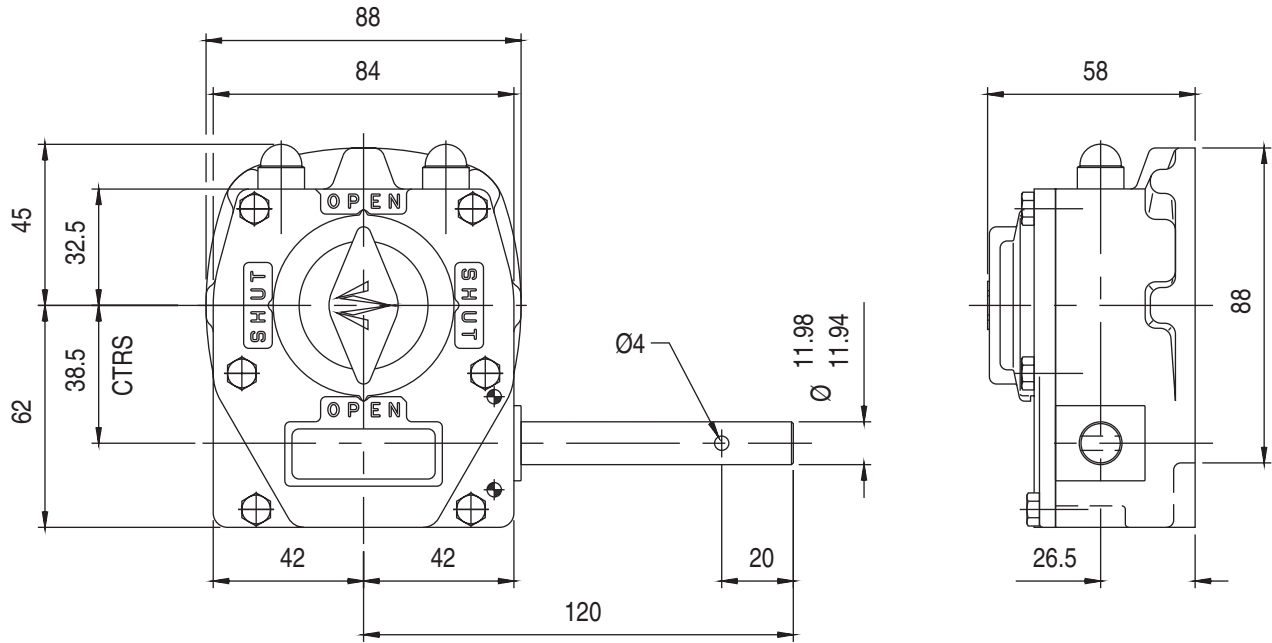

OUTPUT KEYWAY DETAILS
SHOWN IN OPEN POSITION

GENERAL INFORMATION

TRAVEL.....90° +/- 5° AT BOTH ENDS
 RATIO.....40:1
 TURNS TO CLOSE.....10

MECHANICAL ADVANTAGE.....11.0 +/- 10%
 MAXIMUM OUTPUT TORQUE.....250 Nm
 MAXIMUM INPUT TORQUE.....22.7 Nm

MOUNTING HOLE DETAIL: PREFERRED....F07 (4 x M8 ON 70 PCD)
 MAXIMUM.....F07
 MINIMUM.....F05 (4 x M6 ON 50 PCD)

APPROXIMATE WEIGHT.....2.6 Kg (excluding handwheel)

HANDWHEEL DATA	
TYPE	DIA
SR5	125
SR8	200



OPPERMAN MASTERGEAR

Hambridge Road, Newbury, Berkshire, RG14 5TS. ENGLAND
 Telephone: (01635) 811500 Telefax: (01635) 811501



DIMENSIONS
IN

SCALE

DRAWING
No.

MM

1:2

ME-15320

THIS DRAWING/DESIGN IS THE PROPERTY OF OPPERMAN MASTERGEAR LTD. AND ©
 MUST NOT BE USED OR COPIED WITHOUT THEIR SPECIFIC WRITTEN CONSENT.

REV. B
 03FEB98