

ACTUATOR: 9801

SLO39

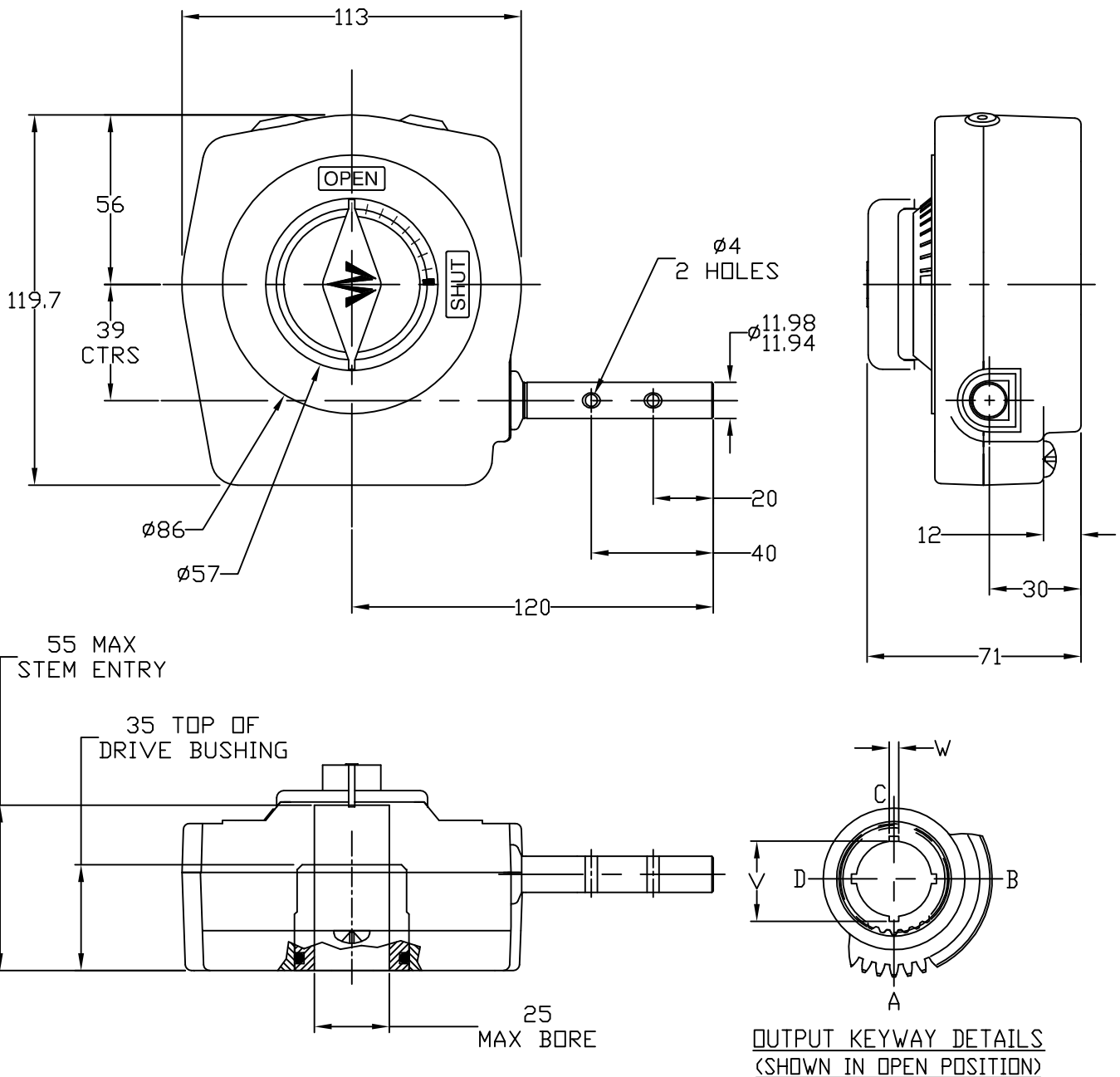

GENERAL INFORMATION

TRAVEL.....90° ±5° AT BOTH ENDS
 RATIO.....40:1
 TURNS TO CLOSE.....10
 MECHANICAL ADVANTAGE...11 ±10%

MAX. OUTPUT TORQUE (1000 CYCLES)...271 Nm
 MAX. OUTPUT TORQUE (2000 CYCLES)...226 Nm
 MAX. INPUT TORQUE (1000 CYCLES).....25 Nm
 MAX. INPUT TORQUE (2000 CYCLES).....21 Nm

MOUNTING HOLE DETAIL: PREFERRED...F10 (4 × M10 ON 102 BCD)
 (BSENISO 5211:2011) MAXIMUM.....F10
 MINIMUM.....F05 (4 × M6 ON 50 BCD)

APPROXIMATE WEIGHT.....1.59 Kg



MASTERGEAR

A REGAL BELOIT COMPANY
 5466 EAST ROCKTON RD. · SOUTH BELOIT, IL 61080

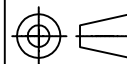

DIMENSIONS
 IN
 MM

SCALE

1/2

DRAWING
 No.

9801

THIS PRINT IS CONFIDENTIAL AND IS THE PROPERTY OF MASTERGEAR. THIS PRINT SHALL NOT BE USED, COPIED OR REPRODUCED IN WHOLE OR IN PART NOR SHALL THE CONTENTS BE REVEALED IN ANY MANNER TO ANYONE UNLESS WRITTEN PERMISSION IS OBTAINED FROM MASTERGEAR.



ST

REV. A
 3/25/08