

- NOTE:
1. GEARBOX RATIOS : 40, 70:1
  2. GEARBOX BASEPLATE: F10/FA10, F12/FA12, F14/FA14 & F16/FA16.
  3. DIMENSIONS WITH "\*" INDICATE COVER REMOVAL ALLOWANCE.
  4. THE INTERFACE PROVIDED FOR MOUNTING THE ACTUATOR OR SECOND STAGE GEARBOX ONTO THE VALVE SHOULD CONFORM TO GOOD ENGINEERING PRACTICES, ENSURING ADEQUATELY TOLERANCED LIMITS FOR PARALLELISM, PERPENDICULARITY AND CONCENTRICITY.
  5. ROTORK CANNOT BE HELD LIABLE FOR DAMAGE TO OUR EQUIPMENT CAUSED BY EXCESSIVE LOADING FROM COVER TUBES, HANDWHEEL AND HAND LEVER.

PARAMETER	VALUE	DESCRIPTION
DRAWING TYPE	A	INSTALLATION DRAWING
ACTUATOR	4	CK(R)C30/60
GEARBOX1	W3	IW3
GEARBOX2	NO	NO G.B.2
CENTORNIK / TERMINAL	B	CTK/3 COND
MECHANISM / MOTOR	S	STD.MECH/SMALL MOT.
HANDWHEEL / REAR / FRONT	0	STD.H.W./STD.REAR./STD.FRNT.
ORIENTATION	0	STD.ORIENT.

<b>CK range</b>	Drawn	TAMIL	30-07-18	<b>Title</b>	DIMENSIONAL DRAWING, CKC30/60 & CKRC30/60, IW3, CENTRONIK / 3 CONDUIT ENTRIES, SMALL MOTOR, STANDARD ORIENTATION	<b>A4</b>	<b>Doc Number</b>	<b>Ver No</b>	<b>Scale</b>	<b>Sheet No</b>
	Checked	BHARAT	30-07-18							
	Approved	JOSE	30-07-18	This drawing and the information it contains are property of Rotork Controls Limited, and they will not be reproduced or disclosed, in whole or in part, without the prior written consent of Rotork.						
						<b>A4W3N0BS00X</b>	<b>1</b>	<b>NTS</b>	<b>1 of 2</b>	

CONDUIT ENTRY HOLE		
Hole	Metric	NPT
A	M32	1 ¼"
B	M25	¾"
C	M20	¾"

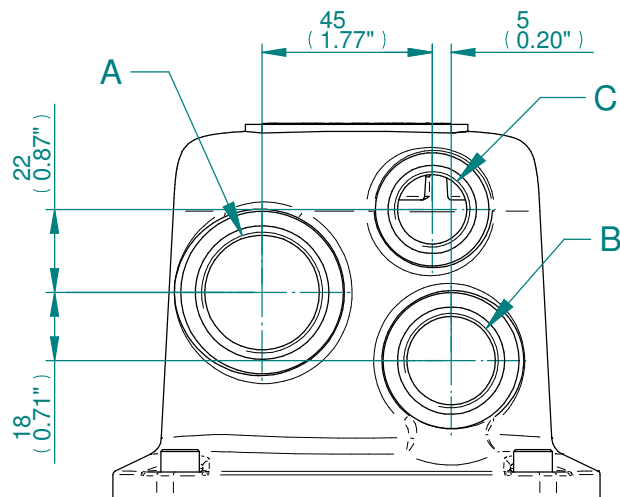

CONDUIT ENTRIES

MOUNTING HOLES CAN BE POSITIONED ON/OFF CENTRES BY REMOVING 4 BOLTS INDICATED AND REPOSITIONING

SEE TABLE FOR MOUNTING DETAILS

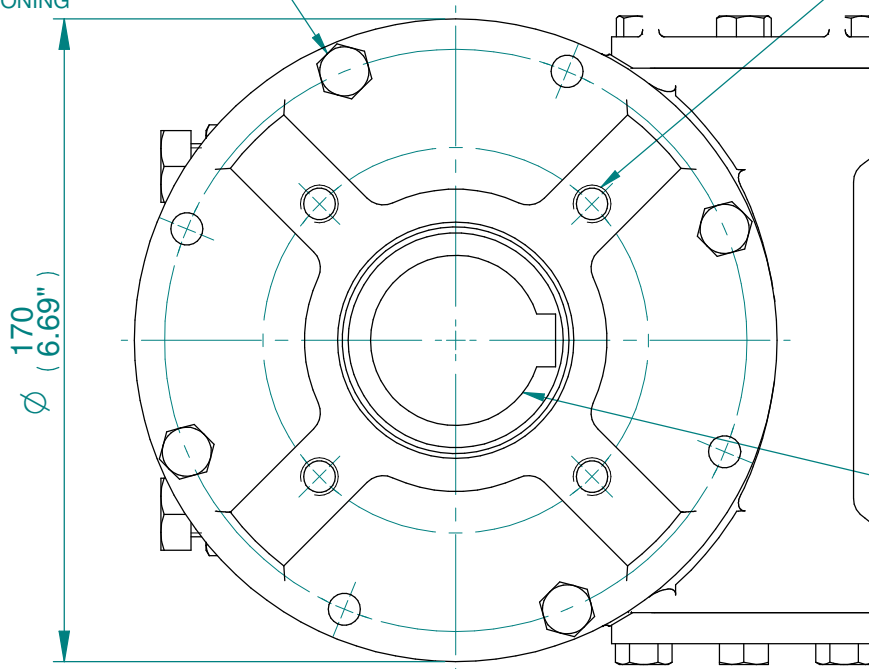

SEE TABLE FOR BORE & KEY DETAILS

IW3 GEARBOX MOUNTING DETAILS

BASEPLATE	X	Y	Z
STANDARD THICKNESS	45	70	81
FILLED THICKNESS	57	82	93
WAFER THICKNESS	71	96	107

STD	MAX BORE SQ KEY		MAX BORE RECTANGULAR KEY	
	BORE	KEY	BORE	KEY
BS4235	-	-	45.0	14X9
BS46	1.625"	7/16"SQ	1.75"	7/16"X5/16"
ANSI B17.1	1.750"	3/8"SQ	1.75"	3/8"X1/4"

BASEPLATE DETAILS		
TYPE	BASEPLATE	HOLE DETAILS (45° OFF CENTRES)
ISO F10	STANDARD	4 HOLES M10X18 (0.71") DEEP ON Ø102.0 (Ø4.02") P.C.
FA10		4 HOLES 3/8"UNCx18 (0.71") DEEP ON Ø102.0 (Ø4.02") P.C.
ISO F12		4 HOLES M12 x 18 (0.71") DEEP ON Ø125 (Ø4.92") P.C.
FA12		4x 1/2"UNC x 18 (0.71") DEEP ON Ø125.7 (Ø4.95") P.C.
ISO F14	FILLED	4 HOLES M16X24 (0.94") DEEP ON Ø140.0 (Ø5.51") P.C.
FA14		4 HOLES 5/8"UNCx24 (0.94") DEEP ON Ø139.7 (Ø5.50") P.C.
ISO F16	WAFER	4 HOLES M20X24 (0.94") DEEP ON Ø165.0 (Ø6.50") P.C.
FA16		4 HOLES 3/4"UNCx24 (0.94") DEEP ON Ø165.0 (Ø6.50") P.C.



Drawn	TAMIL	30-07-18
Checked	BHARAT	30-07-18
Approved	JOSE	30-07-18

**Title** DIMENSIONAL DRAWING, CKC30/60 & CKRC30/60, IW3, CENTRONIK / 3 CONDUIT ENTRIES, SMALL MOTOR, STANDARD ORIENTATION

<b>A4</b>	<b>Doc Number</b>	<b>Ver No</b>	<b>Scale</b>	<b>Sheet No</b>
	<b>A4W3N0BS00X</b>	<b>1</b>	<b>NTS</b>	<b>2 of 2</b>